



Sleeve Yoke / Slip Yoke Assly.



Part No.	Series & Cross (A x B)	No. of Teeth	Total Length (C)		Mating 	Application
			Inches	mm		
SY 202	1312 (46 mm)	16	10½"	270	RT 301	TATA 1312/1612 Ref. O.E.M. 2576 4112 5104
SY 205	1312 (46 mm)	16	12½"	320	RT 304	TATA 1312 LONG
SY 203	1312 (46 mm)	24	10½"	270	RT 302	TATA 1613 TURBO/1109
SY 210	1210 (38 mm)	10	8½"	220	RT 310	TATA 1210 SE (Discontinued, Use SY 212) Ref. O.E.M. 312 410 2108
SY 212	1210 (38 mm)	10	8¼"	210	RT 311 RT 329	TATA 1210 (Replacement for SY 210 also) Ref. O.E.M. 312 410 1908
SY 251	1210 (38 mm)	22	8¼"	210	RT 345	TATA 1210 New Model/709/909
SY 207	SPL 90, L/L 2214 (41.27 x 126)	30	12"	300	RT 306/T RT 307	10" (Thin Splines) L/L 2214, 2516, 3516, 4018/TATA 2515 EX, 2518/Eicher Ref. O.E.M. 8854 4103 2518, P 450 2039 (Heavy Duty Steel Forged)
SY 228	SPL 90, L/L 2214 (41.27 x 126)	30	10"	250	RT 320 RT 322	8" L/L 3516/3014/4018, TATA 1616/1613 (Discontinued, Use SY 221)
SY 226	SPL 90, L/L 2214 (41.27 x 126)	16	12"	300	RT 317/T RT 308	10" (Thick Splines) TATA 2515 EX, L/L 2214, (Heavy Duty Steel Forged)





Sleeve Yoke / Slip Yoke Assly.





Part No.	Series & Cross (A x B)	No. of Teeth	Total Length (C)		Mating 	Application
			Inches	mm		
SY 221	SPL 90, L/L 2214 (41.27 x 126)	16	10"	250	RT 321 RT 323	8" L/L 3516 TATA 1616 (Thick Splines) (Replacement of SY 228 - 30 Spline)
SY 248	SPL 90, L/L 2214 (41.27 x 126)	16	14¼"	360	RT 336/T RT 358/T	TATA L/L Interaxle 1710 Series (With Rubber Cup Threaded) Ref. O.E.M. P 450 3032, 279 000 203
SY 256	SPL 90, L/L 2214 (41.27 x 126)	16	12"	300	RT 336/T	AMW 2518, Interaxle Shaft (With Rubber Cup Threaded)
SY 294	SPL 90, L/L 2214 (41.27 x 126)	16	13"	330	RT 336/T RT 358/T	TATA L/L Interaxle 1710 Series (With Rubber Cup Threaded)
SY 295	SPL 90, L/L 2214 (41.27 x 126)	16	14"	350	RT 3005/T	TATA L/L Interaxle 1710 Series MSL Type (With Rubber Cup Threaded)
SY 204	Tusker (34.92 x 126.20)	16	12½"	320	RT 303	TATA HYWA 2515/3516 (Converted from 28 to 16 spl.) (Heavy Duty Steel Forged)
SY 229	Tusker (34.92 x 126.20)	16	14"	350	RT 342	TATA Interaxle 2516 (Thick Splines)
SY 233	Tusker (34.92 x 126.20)	16	8¼"	210	RT 324/T RT 326/T	L/L Tusker, TATA 1510 TC Ref. O.E.M. P 15000 432
SY 238	Tusker (34.92 x 126.20)	16	9¾"	250	RT 334/T	L/L 1613 Turbo, Euro II Ref. O.E.M. P 450 3039, IA 217 490



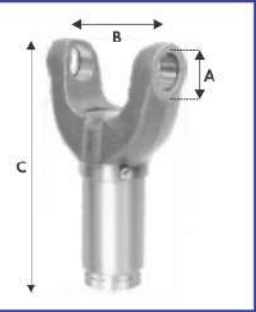

Sleeve Yoke / Slip Yoke Assly.





Part No.	Series & Cross (A x B)	No. of Teeth	Total Length (C)		Mating 	Application
			Inches	mm		
SY 239	Tusker (34.92 x 126.20)	16	10¾"	270	RT 335/T	L/L E-Comet/Stag
SY 244	Tusker (34.92 x 126.20)	16	13½"	340	RT 336/T	TATA L/L Interaxle 1710 Series (With Rubber Cup Threaded) Ref. O.E.M. P 450 3739
SY 250	Tusker (34.92 x 126.20)	16	9½"	240	RT 344/T	TATA 1109 (Converted from 26 to 16 Splines) Ref. O.E.M. 2821 4111 0133
SY 264	Tusker (34.92 x 126.20)	16	8"	200	RT 314/T	TATA 407 N/M, 412
SY 270	Tusker (34.92 x 126.20)	16	8"	200	RT 316/T	TATA 407 N/M, 412, 410, MSL Type (SY 264 Heavy Duty)
SY 272	Tusker (34.92 x 126.20)	16	11½"	290	RT 387/T	Eicher Terra (Converted from 28 to 16 Splines) Ref. O.E.M. P 450 1232, IA 219 213
SY 208	4018 Patti Type (49.20 x 154.90)	16	11"	280	RT 309/T	TATA 4018, L/L 2516, (With Rubber Cup Threaded) Ref. O.E.M. 2841 4112 0102
SY 237	4018 Patti Type (49.20 x 154.90)	16	13"	330	RT 336/T	TATA 4018 Long, 3118, 2518, AWM 2518, Man 25T (With Rubber Cup Threaded) Ref. O.E.M. 2846 4112 0104
SY 235	Taurus (47.62 x 135)	16	9½"	240	RT 331	L/L Taurus Ref. O.E.M. MSL SKU 5055



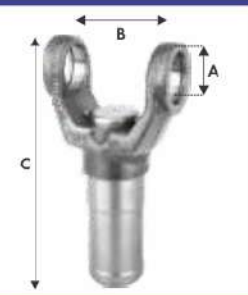

Sleeve Yoke / Slip Yoke Assly.



Part No.	Series & Cross (A x B)	No. of Teeth	Total Length (C)		Mating 	Application
			Inches	mm		
SY 231	L/L 370 (39.68 x 115.40)	16	8"	200	RT 324/T RT 326/T	Bedford, J4/J6, L/L 370/350 Ref. O.E.M. K4-3GB-538
SY 215	TATA 407 (30 x 81.80)	16	6½"	170	RT 312/T RT 315/T	TATA 407/407 Turbo N/M Ref. O.E.M. 2651 4110 0125
SY 217	Canter (30.17 x 106.30)	16	7½"	190	RT 333/T RT 314/T RT 399/T	Canter / TATA 407 Turbo Ex / 709/909 Ref. O.E.M. 2641 4111 0123
SY 263	Canter (30.17 x 106.30)	16	7½"	190	RT 372	TATA 407 N/M, MSL Type
SY 299	Canter (30.17 x 106.30)	16	9"	230	RT 330/T RT 399/T	Canter N/M, Swaraj Mazda
SY 252	Pickup (34.92 x 106.35)	16	8"	200	RT 346/T RT 314/T RT 367/T	TATA 407 Pickup N/M, MSL Type 1480 Series
SY 268	Pickup (34.92 x 106.35)	16	9"	230	RT 386/T	TATA 407 Pickup N/M, MSL Type (Long)
SY 276	Pickup (34.92 x 106.35)	16	9"	230	RT 391/T	TATA 407 Pickup N/M, (Converted from 22+2 Knock off = 24 to 16 Spline) SY 296 Heavy Duty
SY 296	Pickup (34.92 x 106.35)	22	9"	230	RT 3006/T RT 3007/T	TATA 407 Pickup N/M, (22+2 Knock off)
SY 218	DCM (30.17 x 92)	16	6½"	170	RT 319/T RT 372/T	TATA 407 N/M MSL Type Ref. O.E.M. MSL 3320 207

